

RAYNOR®

COMMANDER™



GARAGE DOOR OPENER



RAYNOR COMMANDER™ - TAKES CHARGE OF A SMOOTH OPERATION

Dependability. Security. And smooth, quiet operation. You get it all with the Commander™ garage door opener from Raynor. Powered by a 1/2 hp screw drive motor, it comes complete with several safety features designed to protect you, your family and your home. And with our lifetime motor warranty, you are assured maximum performance day-in and day-out.

For professional installation, call your Raynor Dealer today.

CONVENIENT FEATURES.

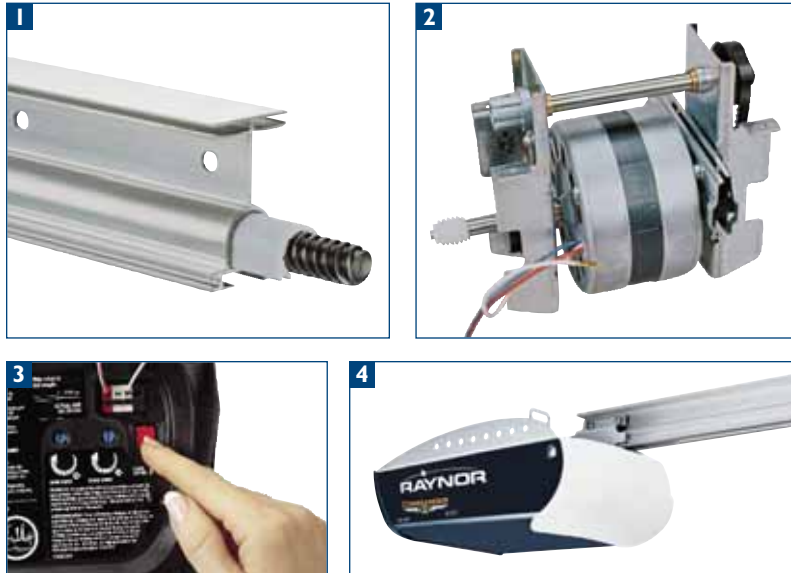

1. Drive Screw. The drive screw has no metal-to-metal contact for smooth, quieter operation. **2. Motor Vibration Isolation System.** this patented technology offers powerful, super-quiet operation that's trouble-free, year after years. **3. "Smart" Door Opener.** This exclusive features lets you electronically program security codes from the control panel or the powerhead - easier and faster than ever before. **4. Adjustable Light Delay.** Allows you to select from 1 1/2, 2 1/2, 3 1/2, and 4 1/2-minute light delay settings.

SAFETY & SECURITY DEVICES.



1. PosiLock™ Security System. Once your garage door goes down, it's securely locked so an intruder cannot gain access. **2. Protector System™ Photo Eyes.** Project an invisible beam across the door opening. If any object breaks the light beam while closing, the door will stop and reverse direction to full open position.



The in-vehicle universal remote control. See your automobile dealer for availability.



Enhanced Range feature allows you to open & close your garage door from greater distances.



Provides superior protection from outside radio signal interference, now operating at 315 MHz.

STANDARD ACCESSORIES.



1. Premium Multi-Function Control Panel. Opens/closes door and turns garage door opener lights on/off from inside garage. Locks out radio signals while you're away. Includes an adjustable light timer and illuminated oversized push button. **2. Safety Signal™ Transmitter.** Selects a new code from over 100 billion possibilities with every use. Makes it virtually impossible for burglars to capture your transmitter's code. Operates up to three garage doors.

OPTIONAL ACCESSORIES.



1. Safety Signal™ Keyless Entry. Opens and closes your door when you enter a 4-digit code. Enter a temporary code that allows guests and service people temporary access with a specific number of activations for a chosen length of time. **2. Premium Motion-Detecting Control Panel.** A "hands-free" motion detector turns your opener lights on when you enter the garage. **3. Mini Safety Signal™ Remote Control.** Convenient size to carry on key chain, in pocket or purse. Operates up to three garage doors and turns opener lights on and off.

Check with your Raynor dealer for additional optional accessories.



www.raynor.com

1-800-4-RAYNOR (472-9667)

Raynor Worldwide
P.O. Box 448, 1101 East River Road
Dixon, IL 61021-0448