

DOOR NUMBER	QTY	OPENING		ACTUAL		MODEL	JAMB	MOUNTING	LOCK	PANELS	PANELS	SECTION NUMBER OPEN FOR GLASS							
		WIDTH	HEIGHT	WIDTH	HEIGHT							W	S	M	ANGLE	B	R	A	R
												1	2	3	4	5	6	7	8

ALUMAVIEW STANDARD

OPENING WIDTH

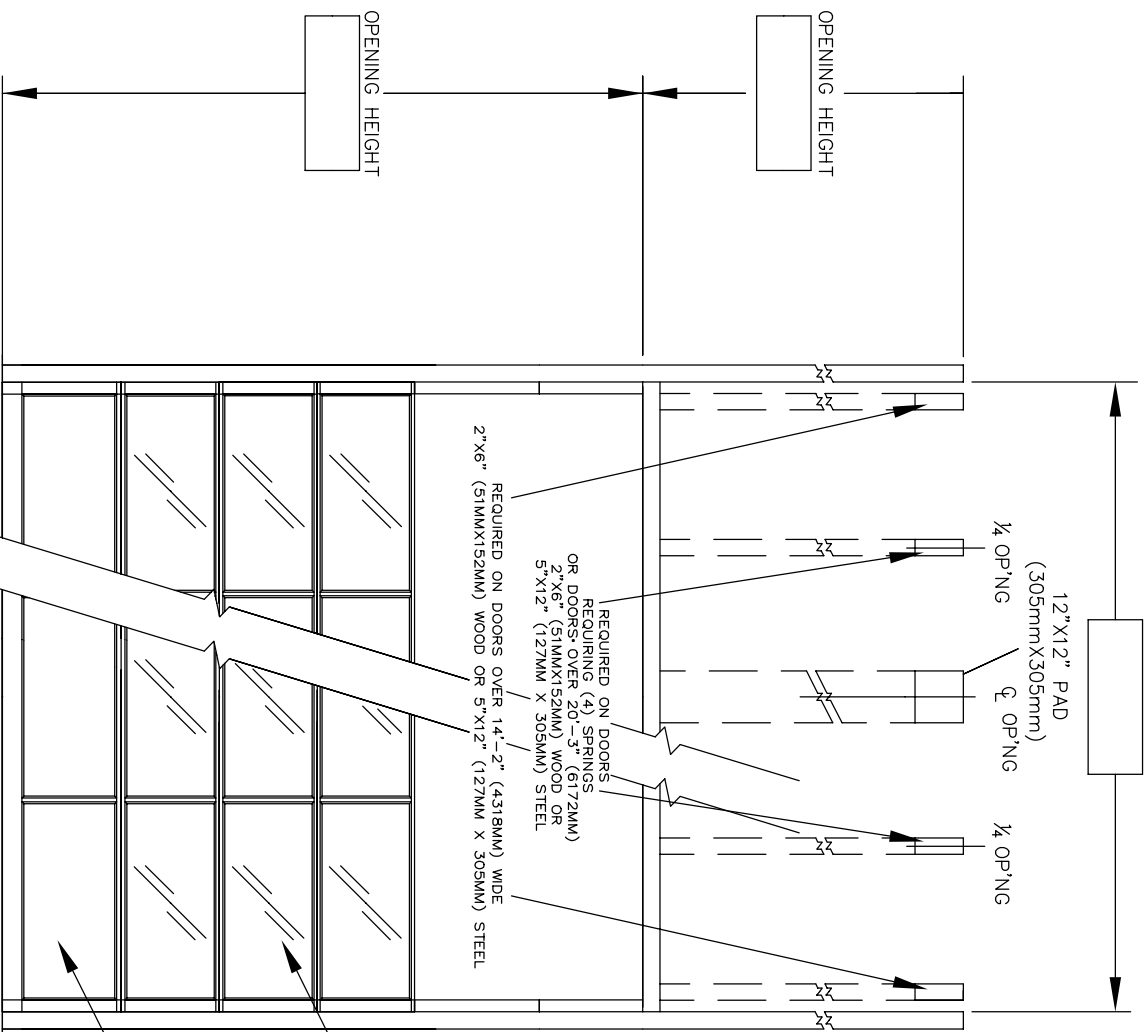

FULL VIEW WINDOWS
 IF REQUIRED, SEE LITE
 NOTES AND DOOR SCHEDULE
 (MARK GLASS TYPE UNDER
 NOTES AND USE "C" IN
 DOOR SCHEDULE)

paneled section
 (MARK DOOR SCHEDULE
 WITH "P" ACCORDINGLY)

INTERIOR ELEVATION

JOB:	
DISTR:	
CONTR:	
ARCH:	
	NR:2902457

1) DOORS SHALL BE RAYNOR SECTIONAL OVERHEAD TYPE ALUMAVIEW STANDARD TYPE AS MANUFACTURED BY RAYNOR GARAGE DOOR CO. SECTIONS SHALL BE 1-3/4" (44.4mm) THICK 6063T6 ALUMINUM ALLOY FRAME WITH .050" (1.3mm) THICK ALUMINUM PANELS, STILES, AND RAILS TO BE JOINED TOGETHER WITH 1/4" (6.4mm) RAYNOR STEEL ANCHORS AND WELDED WITH FOLDED BUTTER BOTTOM/TOP RAILS TO BE 2-5/8" (66.7mm) OR 4-5/8" (117.5mm) COMBINED DIMENSION OF THE TWO MEETING INTERMEDIATE RAILS TO BE 1-1/2" (38.1mm). END STILES SHALL BE 2-5/8" (66.7mm) ENCLOSED TYPE IN LIEU OF OPEN END TYPE. INTERMEDIATE RAILS TO HAVE INTEGRAL REINFORCED WEB T-368 (26.9MM) DEEP BOTTOM FLANGE EXPANSION AND PANELS TO BE FINISHED AND CLEAR ANODIZED TO MEET SPEC. 204RT SPECIAL ANODIZED FINISHES OR ARMORBRITE COLORS AVAILABLE.

- GLASS (CLEAR)----- (DSB 3/16"(4.8MM) OR DSB 1/4" (6.4MM))
- GLASS (WIRE)----- (DSB 3/16"(4.8MM) OR DSB 1/4" (6.4MM))
- GLASS (TEMPERED)----- (1/8"(3.2MM), 3/16"(4.8MM) OR 1/4" (6.4MM))
- PLEXIGLASS----- (1/8"(3.2MM) OR 1/4" (6.4MM))
- LEXAN----- (1/8"(3.2MM) OR 1/4" (6.4MM))
- LOCKING - CREMONE TYPE BOLT ENGAGES SLOT IN TRACK, ----- HAND SIDE. FIVE PIN TUMBLER CYLINDER OUTSIDE - NIGHT LATCH INSIDE.
- LOCKING - SPRING LOADED SLIDE BOLT ENGAGES SLOT IN TRACK. OPERABLE FROM INSIDE ONLY - MAY BE MOUNTED EITHER SIDE
- LOCKING - OMIT LOCK.
- LOCKS SHOULD NOT BE SUPPLIED WITH AN ELECTRIC OPERATED DOOR WITHOUT A LOCK INTERLOCK SWITCH.

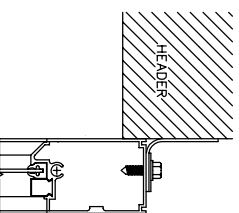

HEADER SEAL

