

DOOR NUMBER	QTY	OPENING		ACTUAL		MODEL	JAMB		LOOK	PANELS WIDE	SECTION NUMBER OPEN FOR GLASS							
		WIDTH	HEIGHT	WIDTH	HEIGHT		W	S			M	ANGLE	E	B	R	K	T	H
											1	2	3	4	5	6	7	8



JOB: \_\_\_\_\_  
 CONTR: \_\_\_\_\_  
 ARCH: \_\_\_\_\_

NR: 2902473

## ALUMAVIEW OPTIMA

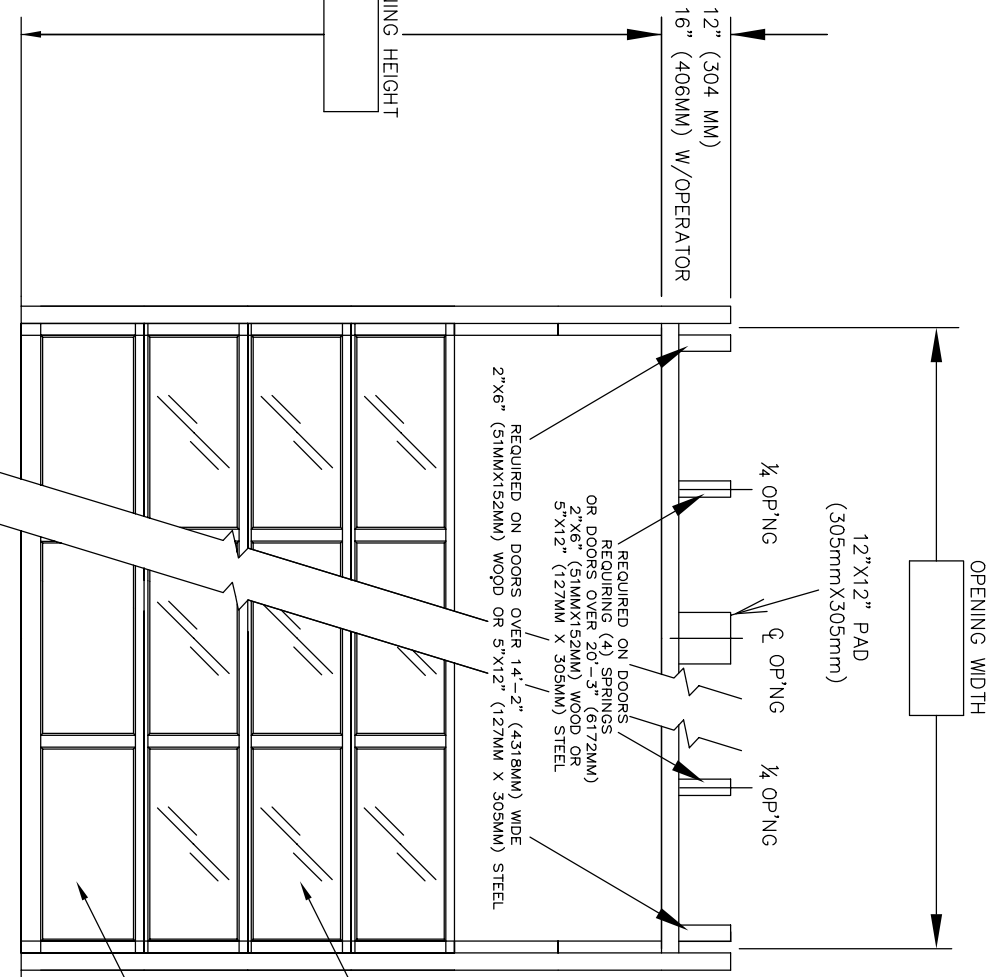

FULL VIEW WINDOWS  
 IF REQUIRED, SEE LITE  
 NOTES AND DOOR SCHEDULE  
 (MARK GLASS TYPE UNDER  
 NOTES AND USE 'G' IN  
 DOOR SCHEDULE)

PANELLED SECTION  
 (MARK DOOR SCHEDULE  
 WITH 'F' ACCORDINGLY)

### INTERIOR ELEVATION

- 1) DOORS SHALL BE RAYNOR SECTIONAL OVERHEAD TYPE ALUMAVIEW OPTIMA "H" AS MANUFACTURED BY RAYNOR GARAGE DOOR CO. SECTIONS SHALL BE 2" (50.8MM) THICK 6063T6 ALUMINUM ALLOY FRAME WITH .050" (1.3mm) THICK ALUMINUM PANELS. STILES AND RAILS TO BE JOINED TOGETHER WITH 5/16" (7.9MM) GALVANIZED THROUGH BOLTS. PANELS AND GLASS TO BE COMPLETELY ENGAGED THROUGH ALUMINUM RETAINERS. TOP RAIL TO BE 5-11/16" (130.2mm) TOP RAILS TO BE 3-1/4" (82.5mm) THE COMBINED DIMENSION OF THE TWO MEETING INTERMEDIATE RAILS TO BE 3-3/4" (95.2mm). ENDSILES SHALL BE 3-1/4" (82.5mm) OR 6-1/4" (158.7mm) WIDE. DEPENDING ON SIZE. CENTER STILES TO BE 3-5/8" (92.1mm) WIDE. BOTTOM RAIL OF DOOR TO HAVE VINYL WEATHERSTRIP TO SEAL DOOR TO FLOOR. EXTRUSIONS AND PANELS TO BE ETCHED OR ANODIZED TO 20" (51mm) WIDE IN PAINTED BROWN OR WHITE. SPECIAL ANODIZED FINISHES OR ARMOBRITE COLORS AVAILABLE.
- GLASS (CLEAR) \_\_\_\_\_ (DSB 3/16" (4.8MM) OR DSB 1/4" (6.4MM))
  - GLASS (WIRE) \_\_\_\_\_ (DSB 3/16" (4.8MM) OR DSB 1/4" (6.4MM))
  - GLASS (TEMPERED) \_\_\_\_\_ (1/8" (3.2MM), 3/16" (4.8MM) OR 1/4" (6.4MM))
  - PLEXIGLASS \_\_\_\_\_ (1/8" (3.2MM) OR 1/4" (6.4MM))
  - LEXAN \_\_\_\_\_ (1/8" (3.2MM) OR 1/4" (6.4MM))
  - LOCKING - CREMONE TYPE BOLT ENGAGES SLOT IN TRACK, \_\_\_\_\_ HAND SIDE. FIVE PIN TUMBLER CYLINDER OUTSIDE - NIGHT LATCH INSIDE.
  - LOCKING - SPRING LOADED SLIDE BOLT ENGAGES SLOT IN TRACK, OPERABLE FROM INSIDE ONLY - MAY BE MOUNTED EITHER SIDE
  - LOCKING - OMIT LOCK.
  - LOCKS SHOULD NOT BE SUPPLIED WITH AN ELECTRIC OPERATED DOOR WITHOUT A LOCK INTERLOCK SWITCH.

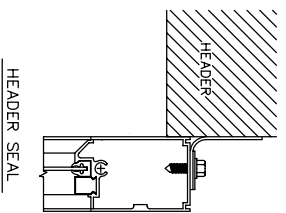

HEADER SEAL

DOOR NUMBER	QTY	OPENING		ACTUAL		MODEL	JAMB MOUNTING			LOCK	PANELS WIDE		SECTION NUMBER OPEN FOR GLASS							
		WIDTH	HEIGHT	WIDTH	HEIGHT		W	S	M		ANGLE/BRKT	1	2	3	4	5	6	7	8	

JOB:  
DISTR:  
CONTR:  
ARCH:



EVEN NUMBERED DOOR HT. + 3'-10" (1168MM) PHBT  
EVEN NUMBERED DOOR HT. + 4'-6" (1168MM) RBT  
EVEN NUMBERED DOOR HT. + 5'-1" (1168MM) RGT

ADD 4" 102MM FOR TROLLEY  
GROOVED CABLE DRUM ON LIVE SHAFT  
OPENING HEIGHT + 27" (686MM)

12" (305MM) PHBT  
12" (305MM) RBT  
15" (305MM) RGT

15" (381mm) RADIUS  
HANGERS NOT SUPPLIED BY RAYNOR GARAGE DOOR CO.

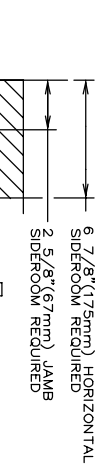
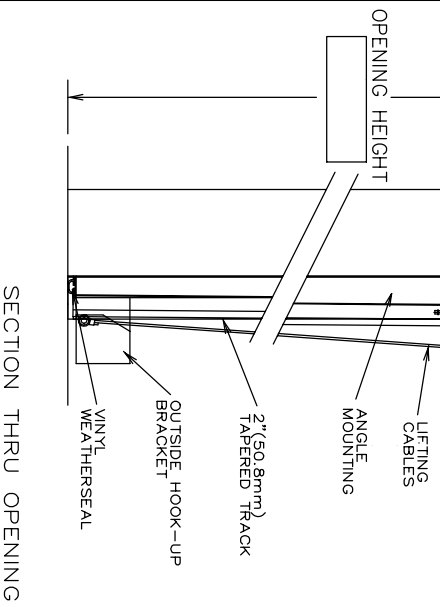

3/32" (2.4mm) CONTINUOUS ANGLE MOUNTING

JAMB DETAIL

- RAYNOR POWERHOIST BASIC (PHBT) 1/2 H.P., 115 VOLT, SINGLE PHASE
- RAYNOR POWERHOIST STANDARD (RBT) \_\_\_ H.P., \_\_\_ VOLT, \_\_\_ PHASE
- RAYNOR POWERHOIST OPTIMA (RGT) \_\_\_ H.P., \_\_\_ VOLT, \_\_\_ PHASE
- WIRING TYPE-SR2 WIRING, MOMENTARY CONTACT OPEN/CLOSE/STOP, SAFETY EDGE TO REVERSE.
- WIRING TYPE-SPECIAL (NOT AVAILABLE WITH PHBT OPERATORS)
- SPECIFY SPECIAL WIRING TYPE \_\_\_\_\_
- PNEUMATIC SAFETY EDGE TO REVERSE
- ELECTRICAL SAFETY EDGE TO REVERSE
- THRU-BEAM PHOTO EYES

ANSI/UL325 REQUIRES THE MOTOR OPERATOR BE MOUNTED A MINIMUM OF 8' ABOVE THE FLOOR OR GUARDING OF THE MOTOR OPERATOR TO PREVENT INJURY. (GUARDS BY OTHERS).

TRACKS- 2" (50.8mm) HOT-DIPPED GALVANIZED TRACK PER ASTM A-653, TRACKS TO BE MOUNTED TO JAMB AND SIDE WALLS FOR SLIDING DOOR TO JAMB HORIZONTAL TRACK TO BE ADEQUATELY REINFORCED WITH CONTINUOUS ANGLE.

HARDWARE- HINGES AND BRACKETS MADE FROM GALVANIZED STEEL. TRACK ROLLERS SHALL HAVE TEN 1/4" (6.4mm) DIAMETER HARDENED STEEL BALLS PER ROLLER.

SPRING COUNTERBALANCE- HEAVY DUTY OIL-TEMPERED WIRE TORSION SPRINGS ON A CONTINUOUS BALL BEARING CROSS-HEADER SHAFT GALVANIZED AIRCRAFT TYPE LIFTING CABLES WITH MIN. SAFETY FACTOR OF 5 TO 1.